



Randolph Austin Company
P.O. Box 988
Manchaca, Texas 78652

Toll Free: 1.800.531.5263
Phone: 512.282.1590
Fax: 512.280.0678
Web: www.randolphaustin.com

600 SERIES Hinged Pump

Max Flow Rate: 3.4 GPM (12.9 LPM)

620-PHO: Pump Head Only

The 620-PHO is the newest addition to the 600 series of pump heads and features a hinged side plate and tube clamp as well as a pump that can be mounted in 90° increments of rotation. The pump housing is machined from an aluminum casting and the internal plate and shaft are stainless steel. The 620-PHO provides easy access to the tubing without separate parts, such as knurled nuts, that can be lost.



620-101: Zero-Max™ Speed Control Pump

The 620-101 is a direct drive unit with a manual speed control providing a speed regulation from 0-400 RPM. This assembly comes with a pump head, Zero-Max speed control, and a 1/4 HP, 115 VAC, 60 HZ, 1 PH, O.D.P. motor mounted on a steel base. The 620-101 provides a cost-effective substitute for AC or DC speed controls and is used for fluid transfer, metering, printing, and other industrial applications.

620-103: Zero-Max Reversible Speed Control Pump

The 620-103 is a direct drive unit with a Zero-Max reversible speed control, that provides a speed regulation from 0-400 RPM in either a clockwise or counterclockwise rotation. This assembly comes with a pump head, Zero-Max speed control, and a 1/4 HP, 115 VAC, 60 HZ, 1 PH, O.D.P. motor mounted on a steel base. The 620-103 provides a cost-effective substitute for AC or DC speed controls and is used for fluid transfer, metering, printing, and other industrial applications.

620-332, 620-352, & 620-362: Vari-Flow™ DC Speed Control Pumps

The 620-332, 620-352, and 620-362 are DC speed control models. The pumps are mounted on a steel base and coupled to a 1/4 HP, geared, IPC-44, 130 VDC, PM motor. Each unit comes with a speed control in a Nema IV enclosure. The controls accept a 4-20 MA or 0-10 VDC signal and have forward/brake/reverse capability. Vari-Flow assemblies are used in applications where precise speed regulation is needed and with systems that require a remote signal for motor or flow control.



Tubing Sizes: The 620-PHO use two interchangeable sizes of tubing: 3/8" I.D. x 5/8" O.D. or 1/2" I.D. x 3/4" O.D.

Industries: Paper & pulp, laboratory, sampling, bilge, ink, and fluid transfer.

Custom assemblies are available upon request. For a quotation please contact our sales office.



600 SERIES Hinged Pump Specifications

Catalog Part #	Description	Motor	Power	RPM	Wt	L x W x H
620-PHO	Pump Head Only	—	—	—	9 lbs	5 1/8" x 5 7/8" x 6 5/8"
620-101	Speed Reducer, Mechanical	1/4 HP, O.D.P.	115 VAC, 1 PH, 60 HZ	0-400	40 lbs	22 3/8" x 11 1/4" x 8 1/2"
620-103	Speed Reducer, Dual Direction, Mechanical	1/4 HP, O.D.P.	115 VAC, 1 PH, 60 HZ	0-400	42 lbs	22 3/8" x 11 1/4" x 8 1/2"
620-332	DC Speed Control Assembly	1/4 HP, PM, 130 VDC, IPC-44	115/230 VAC, 1 PH, 50/60 HZ	3-125	40 lbs	20" x 15 1/2" x 8 1/2"
620-352	DC Speed Control Assembly	1/4 HP, PM, 130 VDC, IPC-44	115/230 VAC, 1 PH, 50/60 HZ	6-250	40 lbs	20" x 15 1/2" x 8 1/2"
620-362	DC Speed Control Assembly	1/4 HP, PM, 130 VDC, IPC-44	115/230 VAC, 1 PH, 50/60 HZ	12-500	40 lbs	20" x 15 1/2" x 8 1/2"

600 SERIES Hinged Pump CAD Drawing

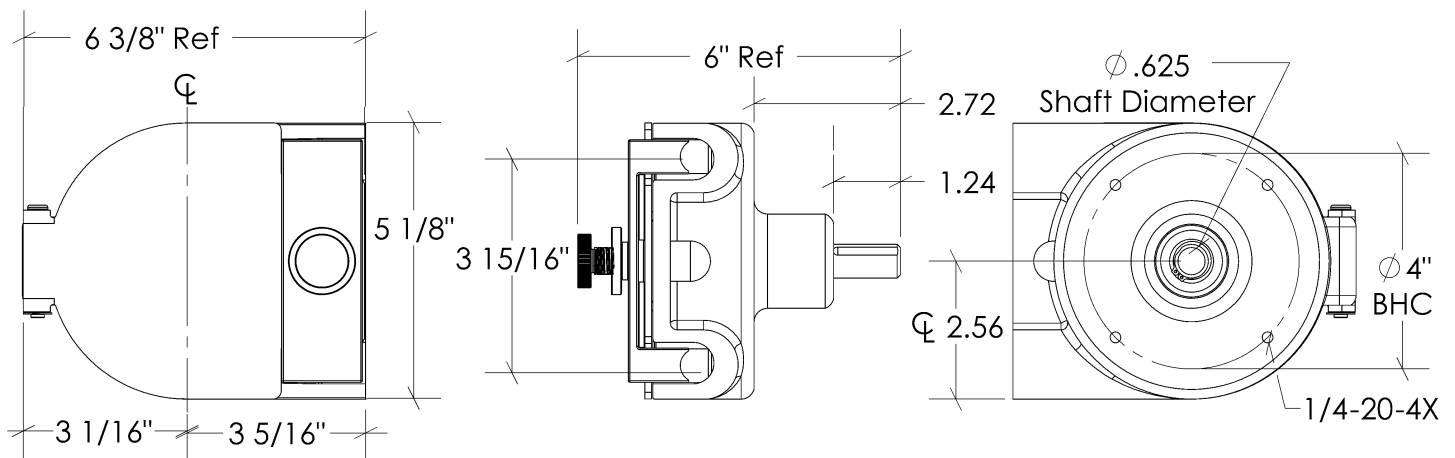

* Zero-Max is a Trademark of Zero-Max Inc.

** Vari-Flow is a Trademark of Randolph Austin Company

